



With recognition toward what we throw away into landfills, LINTEC has developed a line up of films that breakdown easier in the environment. The Mother Green line up is a series of visual marking films that use more ecologically friendly materials.

The Mother Green line up includes Polyolefin's, Acrylics, and Urethane based face films. These are ideal for backlit displays, vehicle marking, and laminate solutions.

ISO 14001 Registered Company



How L-AG G-IJ•SSJ Works

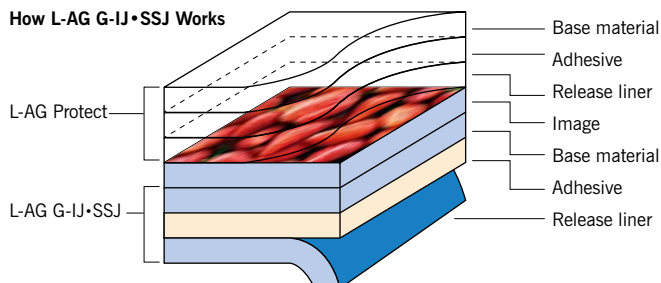



Image:
If printed on clear material it is typically reversed printed and mounted to the inside of the glass.

	Base Material	Color	Thickness	Adhesive	Size	Application	Features
SSJ-AL	 Acrylic	Opaque/Gloss	3.2 mil	Permanent	52 x 98	Mid term outdoor use	Translucent gloss white acrylic film for soft solvent-inkjet, suitable for backlit sign display
SSJ-XUC	 Urethane	Clear	2.8 mil	No adhesive	52 x 98	Mid/long term outdoor use	Clear urethane film for soft solvent-inkjet, with no adhesive
U-1001ZW	 Urethane	White/Gloss	2.8 mil	Permanent gray	53 x 98	Mid/long term outdoor use	Urethane film for soft solvent-inkjet
Y-1002ZW	 Synthetic paper	White/Gloss	4.4 mil	Permanent gray	54 x 98	Indoor/short term outdoor use	Synthetic paper for soft solvent-inkjet
U-1003RW	 Urethane	White/Gloss	2.8 mil	Gray adhesive for display	53 x 98	Mid term outdoor use	Urethane film for soft solvent-inkjet, with gray adhesive for display

* Size: Inches x Feet

 **Mother Green:** Face film of L-AG Mother Green mainly uses olefin/acrylic type face film. These materials are an environmentally friendly series of the visual marking L-AG system.

G-IJ (Material for Solvent-Inkjet) and SSJ (Soft Solvent-Inkjet)

	Texture	Thickness	Adhesive	Size*	Application	Features
PVC film						
P-223RW*1	Gloss white	3.2 mil	High tack gray for display	50 x 98	Medium-to-long-term outdoor use	Durable PVC film, gloss white.
P-224RW	Gloss white	3.2 mil	Removable high tack gray	50 x 98	Medium-to-long-term outdoor use	Durable PVC film, gloss white.
P-280RW*1	Gloss white	3.2 mil	High tack gray for display	54 x 98 55 x 98	Medium-to-long-term outdoor use	Durable PVC film, gloss white.
P-282ZW	Gloss white	3.2 mil	High tack gray	54 x 98 55 x 98	Medium-to-long-term outdoor use	Durable PVC film, gloss white.
P-283ZW	Translucent white	3.2 mil	High tack	54 x 98	Long-term outdoor use	Durable PVC film, suitable for backlit sign display.
P-242RW*1	Matte white	3.2 mil	Gray adhesive for display	60 x 98	Medium-to-long-term outdoor use	Durable PVC film, matte white, with film release liner. Made-to-order item.
P-243RW*1	Matte white	3.2 mil	Gray adhesive for display	54 x 98 55 x 98	Medium-to-long-term outdoor use	Durable PVC film, matte white.
P-247ZW	Matte white	3.2 mil	High tack gray	54 x 98 55 x 98	Medium-to-long-term outdoor use	Durable PVC film, matte white.
P-249ZW	Gloss white	3.2 mil	High tack gray	54 x 98 55 x 98	Short-term outdoor use	Economy grade, PVC film, gloss white.
P-244RW*1	Matte white	3.2 mil	High tack gray for display	54 x 98 55 x 98	Short-term outdoor use	Economy grade, PVC film, matte white.
P-289ZW	Matte white	5.4 mil	High tack gray	54 x 98	Short-term outdoor use	Economy grade, PVC film, gloss white, thick type.
P-294ZW	Gloss white	5.4 mil	High tack gray	54 x 98	Short-term outdoor use	Economy grade, PVC film, matte white, thick type.
P-284ZC	Clear	3.2 mil	High tack	54 x 98 55 x 98	Short-term outdoor use	Suitable for backlit sign display and window display.
P-245RC	Clear	3.2 mil	Removable clear adhesive	54 x 98 55 x 98	Short-term outdoor use	Suitable for backlit sign display and window display.
Durable PVC film with Aluminum foil						
P-212ZW*2	Gloss white	–	High tack	48 x 164	Outdoor use	Suitable for irregular and rough surface.
Tent material for backlit usage						
X-501	White	–	No adhesive	54 x 98	Short-term outdoor use	Suitable for backlit sign display.
White Tarpaulin						
X-502	White	–	No adhesive	54 x 98	Short-term outdoor use	White Tarpaulin.
Perforated PVC film						
X-510	White	8.0 mil	Removable	54 x 98	Short-term outdoor use	Suitable for window display.
X-513	White	8.0 mil	Removable	54 x 98	Short-term outdoor use	Suitable for window display. The hole'size is smaller than X-510.
PVC film						
P-1801ZW	Gloss white	4.8 mil	High tack gray	54 x 98 55 x 98	Medium-to-long-term outdoor use	Durable PVC film, gloss white.
P-1802RW	Gloss white	3.2 mil	Gray adhesive for display	54 x 98	Medium-term outdoor use	Durable PVC film, gloss white.
P-1803ZW	Matte white	4.0 mil	High tack gray	50 x 98	Medium-to-long-term outdoor use	Durable PVC film, matte white.
P-286ZS	Gloss silver	2.4 mil	High tack	36 x 33	Medium-to-long-term outdoor use	Durable PVC film, gloss silver.
P-287ZG	Gloss gold	2.4 mil	High tack	36 x 33	Medium-to-long-term outdoor use	Durable PVC film, gloss gold.
P-288ZS	Sliver hairline	2.4 mil	High tack	36 x 33	Medium-to-long-term outdoor use	Durable PVC film, silver hairline.
X-514	White	135.0 mil	High tack	43 x 98	Short-term outdoor use	Durable PVC film for solvent-inkjet, with easy application handling. Made-to-order item.

G-IJ (Material for Solvent-Inkjet) and SSJ (Soft Solvent-Inkjet)

	Texture	Thickness	Adhesive	Size*	Application	Features
Polyester film						
E-1000ZC	Clear	3.0 mil	High tack	39 x 98	Indoor or short-term outdoor use	Clear polyester film for soft solvent-inkjet, suitable for glass display.
Pet film with removable PSA						
E-1004RC	Clear/Gloss	2.0 mil	Clear removable	48 x	Outdoor use	Outdoor deco, labels and signs.
Acrylic film						
SSJ-AW	Gloss white	3.2 mil	High tack gray	52 x 98	Medium-term outdoor use	Acrylic film for soft solvent-inkjet, with high tack gray adhesive.
SSJ-AL	Translucent gloss white	3.2 mil	High tack	52 x 98	Medium-term outdoor use	Translucent gloss white acrylic film for soft solvent-inkjet, suitable for backlit sign display.
Urethan film with carrier						
SSJ-XUC	Clear	2.8 mil	No adhesive	52 x 98	Medium-to-long-term outdoor use	Clear urethane film for soft solvent-inkjet, with no adhesive. In combination with LAG MOUNT MOTHER GREEN series, it can be used for many applications.
Urethan film						
U-1001ZW	Gloss white	2.8 mil	High tack gray	53 x 98	Medium-to-long-term outdoor use	Urethane film for soft solvent-inkjet.
Synthetic paper						
Y-1002ZW	Gloss white	4.4 mil	High tack gray	54 x 98	Indoor or short-term outdoor use	Synthetic paper for soft solvent-inkjet.
Urethan film						
U-1003RW* ¹	Gloss white	2.8 mil	Gray adhesive for display	53 x 98	Medium-to-long-term outdoor use	Urethane film for soft solvent-inkjet, with gray adhesive for display.
G-1100EC	Clear	3.0 mil	No adhesive	41 x 98	Indoor or short-term outdoor use	Clear polyester film for soft solvent-inkjet, with no adhesive.
Polyester film						
M-1101EL	Translucent white	6.6 mil	No adhesive	51 x 98	Indoor or short-term outdoor use	Translucent white polyester film for soft solvent-inkjet, suitable for backlit sign display, with no adhesive.
G-1102EW	Gloss white	8.0 mil	No adhesive	54 x 98	Indoor or short-term outdoor use	Gloss white polyester film for solvent-inkjet, with no adhesive.
PVC film						
P-1201RL* ¹	Embossed Matte	4.8 mil	High tack for display	50 x 98	Indoor or short-term outdoor use	Mist-pattern-embossed matte PVC film for window and glass partition displays.
P-1211RL* ¹	Embossed Matte	4.8 mil	High tack for display	50 x 98	Indoor or short-term outdoor use	Japan-paper-embossed matte PVC film for window and glass partition displays.
P-1210RL* ¹	Embossed Matte	3.2 mil	High tack for display	50 x 98	Indoor or short-term outdoor use	Delustering-pattern-embossed matte PVC film for window and glass partition displays.
P-1218RL* ¹	Embossed Matte	4.8 mil	High tack for display	50 x 98	Indoor or short-term outdoor use	“Samidare”-pattern-embossed matte PVC film for window and glass partition displays.
P-1220RL* ¹	Embossed Matte	4.8 mil	High tack for display	50 x 98	Indoor or short-term outdoor use	“Komorebi”-pattern-embossed matte PVC film for window and glass partition displays.
P-1221RL* ¹	Embossed Matte	4.8 mil	High tack for display	50 x 98	Indoor or short-term outdoor use	“Yukiakari”-pattern-embossed matte PVC film for window and glass partition displays.

G-IJ (Material for Solvent-Inkjet) and SSJ (Soft Solvent-Inkjet)

	Texture	Thickness	Adhesive	Size*	Application	Features
Paper (the back side color is blue)						
3687	White	5.4 mil	No adhesive	54 x 197	Indoor or short-term outdoor use	Paper for solvent-inkjet, with no adhesive(the back side color is blue).
Paper						
3686	White	9.12 mil	No adhesive	54 x 197	Indoor or short-term outdoor use	Paper for solvent-inkjet, with no adhesive.
3654	White	8.0 mil	No adhesive	54 x 98	Indoor or short-term outdoor use	Photo paper for solvent-inkjet.

* Size: Inches x Feet

*1 The adhesive is high tack and removable type

*2 It depends on the substrate whether you have enough adhesive power or not, so you must test the suitability of this material prior to use.

- If any demand, we can also produce 50M long rolls.
- There are more items available other than the above mentioned items.
- LINTEC reserves the right to change product specifications without notice.
- The item with * mark is a make-to-order item.
- Removability depends on the substrate, so you must test the suitability of this material prior to use.
- Printing result depends on the printer and ink, so you must test the suitability of this material prior to use.
- Wrapping for car, bus and train under some severe conditions, we recommend that you should use laminating film and edge-guard tape.
- The above mentioned applications are only for the surface materials, so you must test the total suitability as the item and also the suitability in combination with ink and other related matters.

Texture		Thickness	Size*	Features
Synthetic Paper				
M-664YW	Matte/White	4.8 mil	50 x 98	Matte, white synthetic paper with gray adhesive and excellent opacity.
M-665YW	Matte/White	4.8 mil	50 x 98	Matte, white synthetic paper with high tack gray adhesive and excellent opacity.
M-668YW	Matte/White	4.8 mil	50 x 98	Matte, white synthetic paper with gray adhesive and excellent opacity.
Polypropylene film				
M-904BW	Matte/White	4.6 mil	50 x 98	Matte, white PP film with gray adhesive and excellent opacity.
			36 x 98	
Olefin film				
MP-21	Matte/White	7.0 mil	50 x 66	Matte, white olefin film with high tack gray adhesive and excellent opacity.
MP-21HQ	Matte/White	8.0 mil	53 x 66	Matte, white olefin film with removable gray adhesive and excellent opacity.
MP-21MX	Matte/White	7.0 mil	43 x 66	Matte, white olefin film with gray adhesive, easy applying type.
MP-21NF	Matte/White	7.0 mil	54 x 66	Matte, white olefin film without adhesive for short-term banner usage.
Polyester film				
M-797EW	Matte/White	3.2 mil	53 x 66	Matte, white polyester film with gray adhesive and excellent opacity.
M-794EW	Translucent/White	4.0 mil	53 x 66	Translucent white polyester film, clear removable adhesive.
G-634EC	Clear	4.4 mil	50 x 98	Clear polyester film, with inkjet coating for dye inks, with no adhesive, for window display usage.
			36 x 98	
G-635EL	Translucent/White	7.4 mil	50 x 98	Translucent white polyester film, with inkjet coating for dye inks, with no adhesive, for backlit usage.
			36 x 98	
Paper				
G-650KW	Gloss/White	–	50 x 98	Gloss white photo paper, with no adhesive.
M-652KW	Matte/White	–	50 x 98	Matte, white water-resistant paper, with high tack adhesive.
			36 x 98	
INJIJOUZU IJ	Matte/White	–	50 x 98	Matte, white recycled paper, with inkjet coating for dye inks, with no adhesive.
			36 x 98	
TENREI IJ	Matte/White	–	50 x 98	Japanese-inspired paper, with inkjet coating for dye inks, with no adhesive.
			36 x 98	
POP-IJ	Fluoresent yellow	–	50 x 98	Yellow paper, with inkjet coating for dye inks, with no adhesive, for POP usage.
			36 x 98	
SERAFORM IJ	Matte/White	–	36 x 98	Anti-flaming paper, with inkjet coating for dye inks, with no adhesive.
Coth • Banner				
Webrid-IJ	Matte/White	10.0 mil	50 x 98	Nonwoven, with no adhesive, for poster/banner usage.
			43 x 66	
Cloth ANF	Matte/White	–	50 x 98	Anti-flaming cloth, with no adhesive.
			36 x 98	
IZ550P	Matte/White	18.8 mil	53 x 66	Matte, white thick olefin film (DuPont film) with both sides inkjet-coated, with no adhesive, for drawing usage.
IZ370P	Matte/White	14.4 mil	53 x 66	Matte, white thin olefin film (DuPont film) with both sides inkjet-coated, with no adhesive, for drawing usage.
IZ340P	Matte/White	12.8 mil	53 x 66	Matte, white olefin film (DuPont), with one side inkjet-coated, with no adhesive, for drawing usage.
IZ320SL	Matte/White	11.2 mil	53 x 66	Matte, white olefin film (DuPont), with one side inkjet-coated, with high tack adhesive.
PVC film				
M-700PW	Matte/White	2.0 mil	48 x 98	Matte, white weather-resistant PVC, with high tack gray adhesive and excellent opacity.
M-706PW	Matte/White	3.2 mil	50 x 98	Matte, white weather-resistant PVC (thick type), with high tack gray adhesive and excellent opacity.
–				
Wallcos JET	Matte/White	–	48 x 98	Matte, white PVC, which is approved as anti-flaming material in Japan, with steel plate as substraite and Wallcos protect as protective film.
Wallcos protect	Embossed/Translucent	–	50 x 98	Clear PVC protective film, which is used together with Wallcos JET to get approval as anti-flaming material in Japan.

* Size: Inches x Feet





How L-AG Mount Works: Example 1

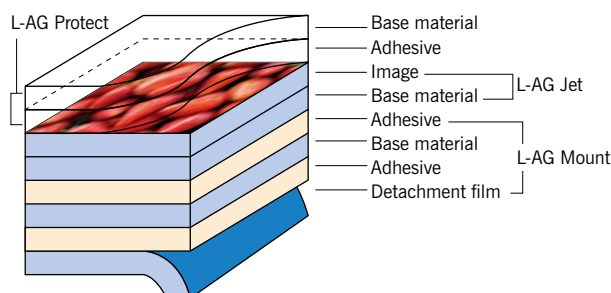

How L-AG Mount Works: Example 2

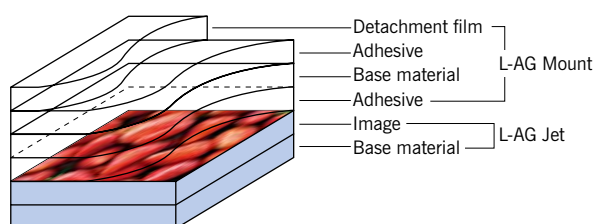

LINTEC Corporation manufactures its “clear laminates” and “Protect” products in state-of the art pressure sensitive coating facilities. Our facilities operate under the most stringent of clean conditions which in turn produce some of the highest quality mounting films in the world.

With recognition toward what we throw away into landfills, LINTEC has developed a line up of films that breakdown easier in the environment. The Mother Green line is a series of visual marking films that use more ecologically friendly materials.

The Mother Green lineup includes Polyolefin's, Acrylics, and Urethane based face films. These are ideal for backlit displays, vehicle marking, and laminate solutions.

ISO 14001 Registered Company

	Color	Thickness	Adhesive	Size*	Application	Features
W-2 Acrylic film						
A-353ZW	White	2.0 mil	Permanent/Permanent gray	43 x 164	Outdoor use	Acrylic film
				53 x 98		The substrate-side adhesive is gray and excellent in opacity
A-354ZW	Opaque white	2.0 mil	Permanent/Permanent	43 x 164	Outdoor use	Translucent-white acrylic film
				53 x 98		Suitable for backlit sign display
A-357ZC	Clear	1.2 mil	Permanent/Super permanent	51 x 98	Outdoor use	UV protected acrylic film
				55 x 98		The substrate-side adhesive is special high tack
W-2 Wood free paper						
K-350ZW	White		Permanent/Permanent	42 x 164	Indoor use	Premium-grade paper
						Suitable for short-term, indoor use
						The substrate-side adhesive is high tack
						We recommend that it be used with “M-070KN100”

* Size: Inches x Feet



Mother Green: Face film of L-AG Mother Green mainly uses olefin/acrylic type face film. These materials are an environmentally friendly series of the visual marking L-AG system.



LINTEC OF AMERICA, INC.

1292 Barclay Blvd.
Buffalo Grove, IL 60089

Tel: 847.229.0547
Fax: 847.229.0548

Toll free: 800.806.8977
www.lintecofamerica.com

Pressure-Sensitive Mounting Materials with Adhesives on Double Sides or Single Side

	Color	Thickness	Adhesive (Graphic side/Substrate side)	Size*	Features
Uon-woven cloth					
MountTL-22NF	White	14g/m² mil	High tack/High tack	41 x 164	One layer. With use of “LAGLA-60 (our laminator)”, lamination and mounting can be done through one process.
Polyester film					
MountTL-83	Clear	1.0 mil	High tack/Display-purpose adhesive	41 x 164	One layer. With use of “LAGLA-60 (our laminator)”, lamination and mounting can be done through one process.
Acrylic film					
A-353ZW	White	2.0 mil	High tack/High tack gray	43 x 164	Acrylic film. The substrate-side adhesive is gray and excellent in opacity.
				53 x 98	
A-354ZW	Translucent white	2.0 mil	High tack/High tack	43 x 164	Translucent-white acrylic film. Suitable for backlit sign display.
				53 x 98	
A-357ZC	Clear	1.2 mil	High tack/Special high tack	51 x 98	UV protected acrylic film. The substrate-side adhesive is special high tack.
				55 x 98	
Synthetic paper					
Y-355RW	White	4.4 mil	High tack/Low tack	43 x 164	The substrate-side adhesive is removable.
Durable PVC film					
P-300ZW	White	2.0 mil	High tack/High tack gray	43 x 164	Durable PVC film. The substrate-side adhesive is gray and excellent in opacity.
				49 x 98	
P-309ZW	White	2.0 mil	High tack/High tack gray	53 x 98	Wider product of P-300ZW.
PVC film					
P-308ZW	White	3.2 mil	High tack/High tack gray	43 x 164	Economy-grade version of “P-300ZW”.
Durable PVC film					
P-301RW	White	2.0 mil	High tack/High tack removable	43 x 164	Durable PVC film. The substrate-side adhesive is removable.
				49 x 98	
PVC film					
P-310RW	White	3.2 mil	High tack/High tack removable	43 x 164	Economy-grade version of “P-301RW”.
P-316RW	White	3.2 mil	High tack/Removable gray	49 x 98	PVC film. The substrate-side adhesive is gray, excellent in opacity and removable.
Durable PVC film					
P-307RC	Clear	2.0 mil	High tack/High tack removable	43 x 164	Durable PVC film, clear, UV protected. Suitable for use with indoor window signs. The substrate-side adhesive is removable.
				49 x 98	
P-352ZW	White	2.0 mil	High tack/High tack gray	42 x 164	Durable PVC film with easy handling. The substrate-side adhesive is gray and excellent in opacity. Only for this product, the graphic side is the outer side of a roll.
P-311ZW	Translucent white	2.0 mil	High tack/High tack	43 x 164	Durable, translucent-white PVC film. Suitable for medium-to-long-term use with illuminated signs. The substrate-side adhesive is high tack.
				49 x 98	
Polyester film					
E-331RC	Clear	1.0 mil	High tack/High tack removable	43 x 164	Clear polyester film for the general use. The substrate-side adhesive is removable.
				49 x 98	
E-334ZC	Clear	2.0 mil	High tack/High tack	53 x 98	Polyester film, clear, UV protected. 1340mm wide width. The substrate-side adhesive is removable.
E-333ZW	Translucent white	3.0 mil	High tack/High tack	43 x 164	Translucent-white polyester film. Suitable for short-tearm use with illuminated signs. The substrate-side adhesive is high tack.
				49 x 98	
E-337RC	Clear	1.0 mil	High tack/Removable	49 x 98	Polyester film, clear. The substrate-side adhesive is removable.
E-338RC	Clear	1.0 mil	High tack/Low tack	49 x 98	Polyester film, clear. The substrate-side adhesive is low tack.
Premium-grade paper (55)					
K-350ZW	White	–	High tack/High tack	43 x 164	Premium-grade paper. Suitable for short-term, indoor use. The substrate-side adhesive is high tack. We recommend that it be used with “M-070KN100”.

Pressure-Sensitive Mounting Materials with Adhesives on Double Sides or Single Side

Color	Thickness	Adhesive (Graphic side/Substrate side)	Size*	Features	
-					
X-500	-	-	High tack	43 x 164	Adhesive only, with no base material. The adhesive is high tack.
Polyester film					
E-430ZW	White	10.0 mil	High tack	43 x 98	10mil(250μm) thick polyester film, for mounting-the-substrate use. Suitable for use with pictures.
				49 x 98	
				53 x 98	
E-433ZC	Clear	10.0 mil	High tack	43 x 98	Clear version of "E-430ZW", for mounting-the-substrate use. The clarity also enables the film to be used as a laminating film.
				49 x 98	
E-432ZW	Translucent white	3.0 mil	High tack	43 x 98	Translucent-white, 3mil(75μm) thick polyester film, for mounting-the-substrate use. It also can be used with tapestries and illuminated signs.
				49 x 98	
				53 x 98	
Synthetic paper					
Y-450ZW	White	3.2 mil	High tack	43 x 98	Synthetic paper, for mounting-the-substrate use. Suitable for use with tapestries.

* Size: Inches x Feet

- Some factors such as the period of application, the specific characteristics of the substrate, etc., can cause the adhesive residue on the substrate after removed.
- The characteristics of some substrates, such as certain plastics, tent fabrics, and expanded materials may cause expansion.
- For LAG MOUNT W items, basically the graphic side is the inner side of a roll, but only for P-352ZW the graphic side is the outer side of a roll.
- For special applications, please consult with your sales representative in advance.
- There are more items available other than the above mentioned items.
- LINTEC reserves the right to change product specifications without notice.





LINTEC Corporation manufactures its “clear laminates” and “Protect” products in state-of-the-art pressure sensitive coating facilities. Our facilities operate under the most stringent of clean conditions which in turn produce some of the highest quality laminate films in the world.

LINTEC has developed a series of visual marking films that use more ecologically friendly materials. The Mother Green lineup includes Polyolefin’s, Acrylics, and Urethane based face films. These are ideal for backlit displays, vehicle marking, and laminate solutions.

ISO 14001 Registered Company

How L-AG Protect Works

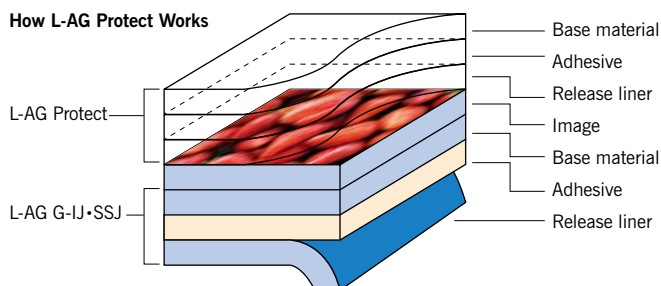





Image:
If printed on clear material it is typically reversed printed and mounted to the inside of the glass.

	Thickness	Look	Size*	Application	Features
Acrylic Film					
G-055AV50 	2.0 mil	Gloss	49 x 98 53 x 98	Mid term outdoor use	Acrylic film with excellent transparency for the general use Suitable for use with flat and simple curved surfaces
M-056AV50 	2.0 mil	Matte	49 x 98 53 x 98	Mid term outdoor use	Matte version of G-055AV50. Suitable for use with flat and simple curved surfaces
G-073AV30 	1.2 mil	Gloss	49 x 98 53 x 98	Short term outdoor use	1.2mil version of G-055AV50, economy grade with paper liner
M-074AV30 	1.2 mil	Matte	49 x 98 53 x 98	Short term outdoor use	1.2mil version of G-056AV50, economy grade with paper liner
G-064AV50 	2.0 mil	Gloss	43 x 98 49 x 98 51 x 98 53 x 98 55 x 98	Mid term outdoor use	Excellent durability, flexibility, heat-resistance, and transparency
M-065AV50 	2.0 mil	Semi matte	43 x 98 49 x 98 51 x 98 53 x 98 55 x 98	Mid term outdoor use	Excellent durability, flexibility, and heat-resistance
M-066AV50 	2.0 mil	Matte	43 x 98 49 x 98 51 x 98 53 x 98 55 x 98	Mid term outdoor use	Excellent durability, flexibility, and heat-resistance
Polypropylene Film					
G-069BN20 	0.8 mil	Gloss	55 x 98	Indoor use	Economy-grade polypropylene film, not UV protected
M-051BN25 	1.0 mil	Matte	38.5 x 164 43 x 164	Indoor use	Economy-grade polypropylene film, not UV protected
Olefin (hydrocarbon) Film					
G-067BN70 	2.8 mil	Gloss	43 x 164 51 x 98 55 x 98	Short term outdoor use	Olefin film shrink resistant, UV protected, excellent flexibility

* Size: Inches x Feet



LINTEC OF AMERICA, INC.

1292 Barclay Blvd.
Buffalo Grove, IL 60089

Tel: 847.229.0547
Fax: 847.229.0548

Toll free: 800.806.8977
www.lintecofamerica.com

Texture		Thickness	UV protection	Size*	Application	Features
Fluoropolymer film						
G-057SV38	Gloss	1.5 mil	○	43 x 98	Long-term outdoor use	Excellent durability, clarity and, protection from dirt.
				53 x 98		
G-059SV25	Gloss	1.0 mil	○	43 x 98	Long-term outdoor use	1mil(25μm) version of G-057SV38.
				53 x 98*		
				55 x 98		
M-063SV25	Matte	1.0 mil	○	43 x 98	Long-term outdoor use	Matte version of G-059SV25.
				53 x 98*		
				55 x 98		
G-053FV25	Luster	1.0 mil	○	51 x 98	Long-term outdoor use	Luster type with superior durability and protection from dirt.
G-054FV50	Luster	2.0 mil	○	43 x 98	Long-term outdoor use	2mil(50μm) version of G-053FV25.
G-052TN50	Gloss	2.0 mil	-	43 x 98	Indoor use	Suitable for use with white boards. Superior durability and protection from organic solvents, not UV protected.
				48 x 98		
Polyester film						
G-030EV50	Gloss	2.0 mil	○	38 x 164	Short-term outdoor use, indoor use	UV protected polyester film.
				43 x 164		
				50 x 98		
				53 x 98		
G-034EV100	Gloss	4.0 mil	○	43 x 164	Short-term outdoor use, indoor use	4mil(100μm) version of G-030EV50. Transparency and texture are enhanced because of the thickness.
				50 x 98		
				53 x 98		
G-044EN25	Gloss	1.0 mil	-	43 x 164	Indoor use	Antibacterial polyester film, protection from dirt and hard-coated, for “WINCOS” laminating.
G-031EN38	Gloss	1.5 mil	-	38 x 164	Indoor use	Polyester film for general use.
				43 x 164		
				50 x 98		
				53 x 98		
G-032EN50	Gloss	2.0 mil	-	43 x 164	Indoor use	2mil(50μm) version of G-031EN38. Superior suitability for lamination.
				50 x 98		
G-033EN100	Gloss	4.0 mil	-	39 x 164	Indoor use	4mil(100μm) version of G-031EN38. Clarity and texture are enhanced because of the thickness. Suitable for use with flat and simple curve surfaces.
				43 x 164		
				50 x 98		
				53 x 98		
Wincos Protect50UH	Gloss	2.0 mil	-	43 x 164	Indoor use	Laminating film for digital print window film “WINCOS”, with hard-coating on surface, for indoor use.
PVC film						
G-002PV50	Gloss	2.0 mil	○	39 x 164	Medium-to-long-term outdoor use	Excellent clarity and durability, for general use.
				43 x 164		
				50 x 98		
M-003PV50*1	Matte	2.0 mil	○	43 x 164	Medium-to-long-term outdoor use	Matte version of G002PV50, for general use.
				50 x 98		
G-015PV50	Gloss	2.0 mil	○	39 x 164	Medium-to-long-term outdoor use	More flexible version of G-002PV50. Suitable for use with flat and simple curve surfaces with excellent clarity and durability.
				43 x 164		
				50 x 98		
G-011PV50*1	Luster	2.0 mil	○	50 x 98	Medium-to-long-term outdoor use	Excellent flexibility.
G-016PV50	Gloss	2.0 mil	○	39 x 164	Medium-to-long-term outdoor use	Paper liner version of G-002PV50. Ecellent durability.
				43 x 164		

	Texture	Thickness	UV protection	Size*	Application	Features
PVC film						
G-000PV80	Gloss	3.2 mil	○	39 x 164	Short-to-medium-term outdoor use	Economy-grade, UV protected PVC film.
				43 x 164		
				50 x 98		
				51 x 98		
				53 x 98		
				55 x 98		
M-001PV80	Matte	3.2 mil	○	39 x 164	Short-to-medium-term outdoor use	Matte version of G-000PV80.
				43 x 164		
				50 x 98		
				51 x 98		
				53 x 98		
				55 x 98		
G-022PV80	Gloss	3.2 mil	○	43 x 164	Short-term outdoor use	Cost-competitive, UV protected PVC film with paper liner. One year outdoor durability.
				50 x 98		
				53 x 98		
M-023PV80	Matte	3.2 mil	○	43 x 164	Short-term outdoor use	Cost-competitive, UV protected PVC film with paper liner. Matte version of G-002PV80.
				50 x 98		
				53 x 98		
M-009PN80	Matte	3.2 mil	–	43 x 164	Indoor use	Economy-grade, matte PVC film. Not UV protected.
				50 x 98		
				53 x 98		
G-027PV50	Gloss	2.0 mil	○	54 x 98	Long-term outdoor use	PVC film, excellent durability, flexibility, and clarity.
M-017PN120	Embossed matte	4.8 mil	–	43 x 98	Indoor use	Embossed matte processed PVC film with superior wear resistance. Suitable for wall art displays and graphic displays.
				50 x 98		
M-018PN120	Embossed matte	4.8 mil	–	43 x 98	Indoor use	Embossed matte processed PVC film with superior wear resistance. Suitable for wall art displays and graphic displays.
				50 x 98		
M-019PN200	Embossed matte	4.8 mil	–	43 x 98	Indoor use	Embossed matte processed PVC film with superior wear resistance. Suitable for wall art displays and graphic displays.
				50 x 98		
M-020PN120	Embossed matte	4.8 mil	–	43 x 98	Indoor use	Embossed matte processed PVC film with superior wear resistance. Suitable for wall art displays and graphic displays.
				50 x 98		
M-021PN120	Embossed matte	4.8 mil	–	43 x 98	Indoor use	Embossed matte processed PVC film with superior wear resistance. Suitable for wall art displays and graphic displays.
				50 x 98		
M-010PN80	Embossed matte	3.2 mil	–	43 x 98	Indoor use	Embossed matte processed PVC film with superior wear resistance. Suitable for wall art displays and graphic displays.
				50 x 98		
				52 x 98		
M-026PV600	Embossed matte	24.0 mil	○	50 x 66	–	Laminating PVC film for graphic displays with superior wear resistance.
Acrylic film						
G-055AV50*2	Gloss	2.0 mil	○	43 x 98	Medium-term outdoor use	Acrylic film with excellent clarity for the general use. Suitable for use with flat and simple curve surfaces.
				53 x 98		
M-056AV50*2	Matte	2.0 mil	○	43 x 98	Medium-term outdoor use	Matte version of G-055AV50. Suitable for use with flat and simple curve surfaces.
				53 x 98		
G-073AV30*2	Gloss	1.2 mil	○	43 x 98	Short-term outdoor use	1.2mil (30μm) version of G-055AV50, cost-competitive with paper liner.
				53 x 98		
M-074AV30*2	Matte	1.2 mil	○	43 x 98	Short-term outdoor use	1.2mil (30μm) version of M-056AV50, cost-competitive.
				53 x 98		

Texture	Thickness	UV protection	Size*	Application	Features	
Acrylic film						
G-064AV50*2	Gloss	2.0 mil	○	43 x 98	Medium-term outdoor use	Excellent durability, flexibility, heat-resistance and clarity.
				50 x 98		
				51 x 98		
				53 x 98		
				55 x 98		
M-065AV50*2	Luster	2.0 mil	○	43 x 98	Medium-term outdoor use	Excellent durability, flexibility and heat-resistance.
				50 x 98		
				51 x 98		
				53 x 98		
				55 x 98		
M-066AV50*2	Matte	2.0 mil	○	43 x 98	Medium-term outdoor use	Excellent durability, flexibility and heat-resistance.
				50 x 98		
				51 x 98		
				53 x 98		
				55 x 98		
M-082AN15*2	Matte	0.6 mil	–	36 x 164	Indoor use	Antibacterial acrylic film with paper liner. Suitable for indoor use.
Polypropylene film						
G-069BN20	Gloss	0.8 mil	–	55 x 98	Indoor use	Economy-grade polypropylene film, not UV protected.
M-051BN25	Matte	1.0 mil	–	39 x 164	Indoor use	Economy-grade, matte polypropylene film, not UV protected.
				43 x 164		
Olefin film						
G-067BN70	Gloss	2.8 mil	○	43 x 164	Short-term outdoor use	UV protected olefin film with excellent flexibility.
				51 x 98		
				55 x 98		
Crystal window						
M-070KN100	Matte	4.0 mil	–	50 x 98	Indoor use	Base material is paper, “Crystal Window”.
				53 x 98		

* Size: Inches x Feet

*¹ The texture may change in high temperature environments. You need to take extra care to keep stock in the summer. Dryers should not be used during processing.

*² For cleaning, LINTEC recommends the use of water or a neutral cleaner. LINTEC does not recommend the use of isopropyl alcohol, white gasoline, or organic solvents because they could damage the film.

- There are more items available other than the above mentioned items.
- LINTEC reserves the right to change product specifications without notice.



Reliable & Highest Quality

LINTEC is pleased to introduce a new lineup of **low-solvent inkjet printable materials**.

LINTEC's **SSJ** (Soft Solvent Jet) Media are ideally suited for making **clear film displays for glass**, as well as **labels and decals**.

LINTEC's clear printing and mounting films are produced in state-of-the-art **clean facilities**, ensuring that your window graphics and glass decorated products will be of the **highest quality**.

SSJ Polyester Films for Solvent Printing

Item Code	Description	Thickness	Size	Adhesive	Usage
E-1000ZC	2 mil Topcoated Clear PET	2 mil	48" x 164'	Permanent	Indoor
E-1004RC	2 mil Topcoated Clear PET	2 mil	48" x 164'	Removable	Indoor
G-1100EC	2 mil Topcoated Clear PET	2 mil	48" x 164'	None	Indoor
E-1005ZW	3 mil Topcoated White PET	3 mil	54" x 98'	Permanent	Indoor
E-434ZW	3 mil White PET Backer	3 mil	54" x 150'	Permanent	Indoor

SSJ PVC Films for Solvent Printing

Item Code	Description	Thickness	Size	Adhesive	Usage
M-010PN80	Dusted (Frosted) PVC	3 mil	49" x 98'	Permanent	Indoor
MSV-1001	Matte Textured PVC	5 mil	49" x 98'	Permanent	Indoor
MSV-1002	Pebbled Textured PVC	6 mil	49" x 98'	Permanent	Indoor
MSV-1005	Crossroad Textured PVC	6 mil	49" x 98'	Permanent	Indoor
MSV-1006	Carbon (Checkered) PVC	6 mil	49" x 98'	Permanent	Indoor
MSV-1007	Scramble Textured PVC	6 mil	49" x 98'	Permanent	Indoor
MSV-1011	Mino (Rice Paper) PVC	5 mil	49" x 98'	Permanent	Indoor
P-291ZW	White Polymeric PVC	3 mil	36" x 164'	Permanent	Outdoor
P-291ZW	White Polymeric PVC	3 mil	61" x 164'	Permanent	Outdoor

How SSJ Works

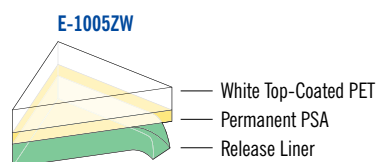
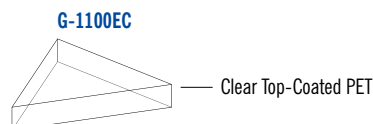
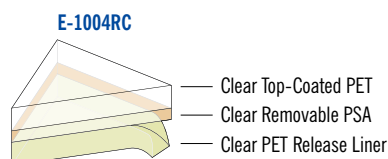
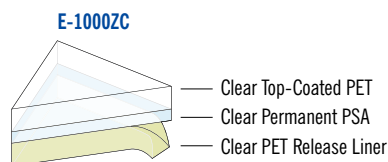

UV Cured Digital Printable Polyester

100% cure of the ink. In general the higher the thickness the more brittle the ink will become leading to reduced scratch resistance. The bandwidth and intensity of UV light exposed to the UV cured ink should be regularly evaluated to ensure optimum cure (adhesion and scratch resistance) performance.

IMPORTANT NOTES

1. If the film is not cured correctly it can introduce up-curl or 'wavy edges' into the product. As the film is designed to be wet applied curl can cause application issues. Product curl at point of application can cause delamination of the film from the glass due to the low adhesion level. It is therefore essential to evaluate all profiles and drying conditions as detailed within this document to ensure good lay-flat properties after printing.
2. It is essential to evaluate the water resistance of the ink system employed. Print the film with UV ink and wet with water, keep the ink soaked with water for a minimum of 5 minutes. After this time check ink scratch resistance. It has been noted some UV inks are hydroscopic and soften when wet. Please refer to the window film installation guidelines for more on this.

PRODUCT DESCRIPTION

A range of printable window films featuring high performance UV ink-jet receptive topcoatings which offer excellent ink adhesion. The polyester films, in combination with the correct UV inks, ink deposit and UV cure produces high performance printed window graphics. The optically clear film and adhesive ensures perfect see-through vision when applied to glass.

Note: Products supplied with paper release liners will reduce clarity compared to films protected with polyester release liners.

ACCLIMATISATION

Prior to printing, store the material in the machine room for a minimum of 24 hours to acclimatize the product.

PRINTING

When initially evaluating the LINTEC UV digital polyester range we recommend that you evaluate your digital printer, UV digital ink and curing in combination with the LINTEC film to ensure good adhesion after optimum UV cure. It is recommended to carry out crosshatch / Sellotape adhesion and wet test (detailed below). These tests should be carried out 24 hours after printing.

INK DEPOSIT AND CURE

The amount of ink deposited onto the UV digital printable polyester should be the minimum amount of ink whilst still ensuring optimum print definition, saturation and performance. High coat weights of UV cured inks can cause issues with ensuring

PRINTED MATERIAL HANDLING

Once the print is dried the material should ideally be hung or left on a flat table to post cure. At this time the ink surface should be exposed to the air and not be in contact with another surface. We recommend 24 hours for full post cure the cure time before installation. Ensure the ink is fully cured before rewinding. If the ink is not fully cured, there is a risk of 'blocking' where the uncured ink bonds to the release liner when it is rewound onto a roll.

PACKAGING FOR TRANSPORTATION

The media should be wound around a tube with ink out facing, poly bagged and then boxed.

APPLICATION

1. The printed materials should be trimmed with new sharp cutting blade.
2. The area where the film is to be applied should be clean and free of any contamination such as silicone.
3. The printed film should be applied using the LINTEC application fluid, Blue solution, to ensure activation of the adhesive whilst using wet application methods. See separate LINTEC Application Instructions leaflet.

The representations of performance and suitability for use contained in this Data Sheet are meant only as a guide. Since only the user is aware of the specific conditions in which the product is to be used, it is the user's responsibility to determine whether the product is suitable for that intended use. Copyright 1995



Design Your Own Decorative Glass.



Now You Can Use Your UV Ink Jet Printer for Decorative Glass Applications!

Clear Polyester Films for UV Curable and Latex Printing

Item Code	Description	Thickness	Size	Adhesive	Usage
E-2000ZC	Optically Clear PET	2 mil	54, 61" x 150'	Permanent	Indoor
E-2001RC	Optically Clear PET	2 mil	54" x 150'	Removable	Indoor
E-2301RC	Clear PET with Paper Liner	2 mil	54" x 150'	Removable	Indoor
E-2100ZC	Scratch Resistant Optically Clear PET	2 mil	61" x 150'	Permanent	Indoor
E-2200ZC	Scratch Resistant Optically Clear PET	2 mil	61" x 150'	UV Permanent	Indoor
E-2201RC	Scratch Resistant Optically Clear PET	2 mil	61" x 150'	UV Removable	Indoor
E-2203RC	Scratch Resistant Optically Clear PET	4 mil	61" x 150'	Ultra Removable	Indoor
E-434ZW	3 mil White PET Backer	3 mil	54" x 150'	Permanent	Indoor

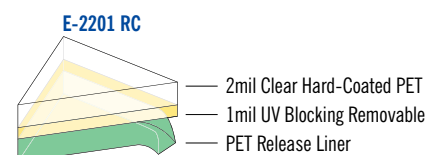
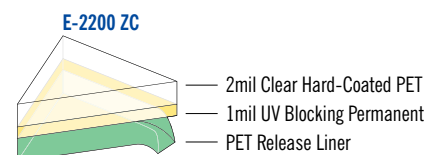
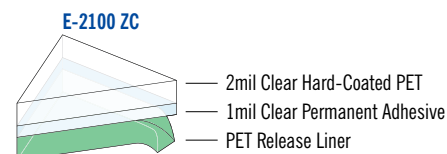
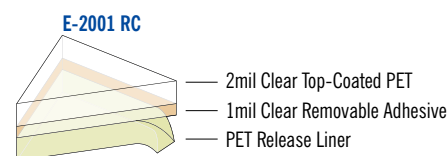
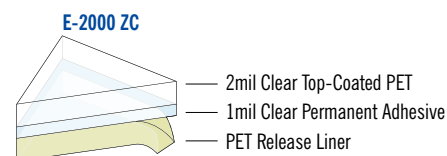

Decorative Polyester Films for UV Curable and Latex Printing

Item Code	Description	Thickness	Size	Adhesive	Usage
MST-1301*	Dusted (Frosted) PET	2 mil	49" x 164'	Permanent	Indoor
MST-1301P	Dusted (Frosted) PET with Paper Liner	2 mil	60" x 164'	Permanent	Indoor
MST-5000*	Super White Textured PET	2 mil	49" x 98'	Permanent	Indoor
MST-5001*	White Mist Textured PET	2 mil	49" x 98'	Permanent	Indoor
MST-5002*	Mist Finish PET	4 mil	49" x 98'	Permanent	Indoor
MST-5003*	Fine Mist (Pebbled) PET	2 mil	49" x 98'	Permanent	Indoor
MST-5011*	Japanese Heavy Rice Paper PET	2 mil	49" x 98'	Permanent	Indoor
MST-5012*	Japanese Light Rice Paper PET	2 mil	49" x 98'	Permanent	Indoor
MST-5051*	Milky PET	2 mil	38" x 98'	Permanent	Indoor
MST-5052*	Light Frost PET	2 mil	38" x 98'	Permanent	Indoor

*Print testing is highly recommended.

PVC Films for UV Curable and Latex Printing

Item Code	Description	Thickness	Size	Adhesive	Usage
M-010PN80	Dusted (Frosted) PVC	3 mil	49" x 98'	Permanent	Indoor
MSV-1001	Matte Textured PVC	5 mil	49" x 98'	Permanent	Indoor
MSV-1002	Pebbled Textured PVC	6 mil	49" x 98'	Permanent	Indoor
MSV-1005	Crossroad Textured PVC	6 mil	49" x 98'	Permanent	Indoor
MSV-1006	Carbon (Checkered) PVC	6 mil	49" x 98'	Permanent	Indoor
MSV-1007	Scramble Textured PVC	6 mil	49" x 98'	Permanent	Indoor
MSV-1011	Mino (Rice Paper) PVC	5 mil	49" x 98'	Permanent	Indoor
P-291ZW	White Polymeric PVC	3 mil	36" x 164'	Permanent	Outdoor
P-291ZW	White Polymeric PVC	3 mil	61" x 164'	Permanent	Outdoor



Lintec Special



www.bciimage.com

866 971-1008

Lintec Item #	UL #	Printable Polyester Films	Adhesive *Removable	Liner	Performance Notes
0850298L9	NO. 5315BD25	1 mil Bright Silver Polyester	PA-T1	11L	High quality metallic polyester films with a strong permanent acrylic adhesive.
0850598L9	NO. 5315BD50	2 mil Bright Silver Polyester	PA-T1	11L	
085251E9K	NO. 5405BZ25	1 mil Sand Matte Silver Polyester	PA-T1E	9K	
085501E9K	NO. 5405BZ50	2 mil Sand Matte Silver Polyester	PA-T1E	9K	
0852698L9	NO. 5415BD25	1 mil Matte Silver Polyester	PA-T1	11L	
0855498L9	NO. 5415BD50	2 mil Matte Silver Polyester	PA-T1	11L	
0856298L9	NO. 5515BD25	1 mil Bright Gold Polyester	PA-T1	11L	
0856398L9	NO. 5515BD50	2 mil Bright Gold Polyester	PA-T1	11L	
0858398L9		1 mil Matte Gold Polyester	PA-T1	11L	
0858798L9		2 mil Matte Gold Polyester	PA-T1	11L	
085231E9K		2 mil Silver Polyester with Matte White	PA-T1E	9K	Silver polyester with a white topcoating.
0855298F8	NO. 5475BZ50	2 mil Silver Polyester with Matte White	PA-T1	8LK2	Ideal for use as a 100% opaque white film.
085969903	NO. 5315BL200	8 mil Bright Silver Polyester	PA-T1	11LL	Heavy layflat liner for easy sheeting.
0860398L9	NO. 6315BD25	1 mil Brushed Bright Silver Polyester	PA-T1	11L	High quality metallic polyester films with a very strong permanent acrylic adhesive.
0860698L9	NO. 6315BD50	2 mil Brushed Bright Silver Polyester	PA-T1	11L	
0860298L9	NO. 6415BD25	1 mil Brushed Matte Silver Polyester	PA-T1	11L	
0860598L9	NO. 6415BD50	2 mil Brushed Matte Silver Polyester	PA-T1	11L	
0863098L9	NO. 6515BD25	1 mil Brushed Bright Gold Polyester	PA-T1	11L	
0863698L9	NO. 6515BD50	2 mil Brushed Bright Gold Polyester	PA-T1	11L	
0842433L9	NO. 3755AD25	1 mil Clear Polyester	NPL	11L	Printable clear polyester that is dimensionally stable in heat or cold.
0844533L9	NO. 3755AD50	2 mil Clear Polyester	NPL	11L	
0844567L9		2 mil Clear Polyester	MF*	11L	Removable Adhesive
084333338	NO. 3755AU38	1.5 mil Clear Polyester	NPL	PET38	Optically clear for high clarity applications.
08P581E9K	NO. 4615BZ50	2 mil Satin White Polyester	PA-T1E	9K	Printable white polyester with a strong permanent acrylic adhesive.
0800R1E9K	NO. 4815BZ50	2 mil Matte White Poyester	PA-T1E	9K	
Printable High Temperature Films					
01-430		2 mil High Temperature White Polyester	PN	8LKY	Can withstand up to 400F
01-861		2 mil Gloss White Polyimide	HT	8LKY	Can withstand up to 580F

Printable Chemical Resistant Polyester					
01-980		2 mil Matte White Polyester			
Printable Vinyls					
0802C0B0A		3.2 mil Gloss White PVC	P	11K	Permanent adhesive vinyl
0802F0B0A		4 mil Gloss White PVC	P	11K	
0802A0B0A		3.2 mil Matte White PVC	P	11K	
0802D0B0A		4 mil Matte White PVC	P	11K	
0802B0B0A		3.2 mil Clear PVC	P	11K	
0800E0C0A		4 mil Clear PVC	M*	11K	Removable adhesive vinyl
0802E0B0A		4 mil Clear PVC	P	11K	Permanent adhesive vinyl
0815398L7		4 mil Red PVC	PA-T1	11BY*	Printable colored vinyls with a strong acrylic permanent adhesive and 2 side polycoated wood free paper liner.
0815698L7		4 mil Blue PVC	PA-T1	11BY*	
0815298L7		4 mil Yellow PVC	PA-T1	11BY*	
0815598L7		4 mil Green PVC	PA-T1	11BY*	
0815998L7		4 mil Black PVC	PA-T1	11BY*	
0815198L8		4 mil Matte White PVC	PA-T1	11BY*	Very light tack removable adhesive.
400501522		5 mil Matte White PVC	N-Tack*	11GM	
400501522		5 mil Matte Clear PVC	N-Tack*	11GM	
Printable Synthetic Papers					
083761EL9	NO. 7015BD80	3.2 mil Matte White Yupo (UV)	PA-T1E	11L	Extremely strong permanent adhesive.
08376BW84		3.2 mil Matte White Yupo (UV)	PM	8LK	
08K4298L9	NO. 7015BD110	4.3 mil Matte White Yupo (UV)	PA-T1	11L	
083599884	NO. 7025BZ90	3.5 mil Matte White Yupo (SG)	PA-T1	8LK	
08K32C287		4.7 mil Matte White Yupo (Thermal)	PC	8K	Designed for cold such as frozen food
08357DXL7		2.5 mil Matte White Yupo for Correction	P065D	BY	
0838898F8	NO. 9015BZ80	3.2 mil Peach (SP)	PA-T1	8LK2	Gray adhesive for blackout applications.
083761E9K	NO. 7015BZ80	3.2 mil Matte White Yupo (UV)	PA-T1E	9K	
083760180		3.2 mil Matte White Yupo (UV)	PW	8K	
083766784		3.2 mil Matte White Yupo (UV)	MF*	8LK	Removable adhesive vinyl
08376C280		3.2 mil Matte White Yupo (UV)	PC	8K	Designed for cold such as frozen food
083760JL7		3.2 mil Matte White KPY Somen	R130	11BY*	Textured synthetic with rubber adhesive.
80169380		2.8 mil Pearl White	SG	8K	

Overlaminating Films					
084160X79	NO. 3705AX16	.65 mil Clear Polyester			
01-278		1 mil Gloss Clear Polyester			
01-288		1 mil Chemical Matte Clear Polyester			
084233379	NO. 3705AX25	1 mil Clear Polyester	NPL	7HL	Clear polyester films with unique finishes designed to enhance image appearance.
084263384	NO. 3105AZ25	1 mil Sand Blasted Matte Clear Polyester	NPL	8LK	
084270X79	NO. 3205AX25	1 mil Matte Clear Polyester	NPL	7HL	
0800G0X79		.75 mil Clear Polypropylene	NPL	7HL	Economical clear polypropylene films for overlaminating.
087403379		1.5 mil Clear Polypropylene	NPL	7HL	
0800N3368		1 mil Matte Clear Polypropylene	NPL	7LK	
08416330E	NO. 3705AV16	.65 mil Clear Polyester	NPL	PET2501	Optically clear for high clarity applications.
Printable Security Films					
08M659884	NO. 5415BZ50	2 mil Matte Silver Void Polyester	PA-T1	8LK	Small void pattern with strong adhesive leaves reliable tamper evident proof.
08M659885	NO. 5315BZ50	2 mil Bright Silver Void Polyester	PA-T1	8LK	
400503758		2 mil Gloss White Destructible PVC	PA-T1	8K	High quality destructible vinyl
03-125		3 mil Satin White Destructible PVC	PA-T2	8K	High quality destructible vinyl
03-500		2 mil Silver Destructible PVC	PA-T1	8K	High quality destructible vinyl
03-700		3 mil Satin White Destructible Polypropylene	AC	8K	More body for easier auto apply
Printable Recyclable Films					
0801BDLL6		2.75 mil Gloss Clear "KEE" Film	P-2041	11YC*	Polyethylene with adhesive designed for recycling with polyethylene products.
0801ADLL6		2.75 mil Gloss White "KEE" Film	P-2041	11YC*	
400501512		2.75 mil Matte Clear "KEP" Film	P-2041	11YC*	Polypropylene with adhesive designed for recycling with polypropylene products.
400501511		2.75 mil Satin White "KEP" Film	P-2041	11YC*	
0800T3379	NO. 8215AX25	1 mil Matte Clear "KES" Film	NPL	7HL	Polystyrene with adhesive designed for recycling with polystyrene products.
400480819	NO. 8015BT65	2.5 mil Matte White "KES" Film	PA-T1	8K	
28050530C	NO. 8135DL120	5 mil Matte White "KES" Film	P-2041	11LL	
28043820C	NO. ABS5DL100	4 mil Matte White "KEA" Film	P-2041	11LL	ABS with adhesive designed for recycling with ABS products.
28046170C	NO. ABS5AX30	1 mil Matte Clear "KEA" Film	NPL	7HL	

Printable Removable Films					
08C66RPRT		2 mil Matte Clear Polyester			
08C62RPRS		3 mil Matte White Yupo (UV)			
Non PVC Film with PVC Feel and Flexibility					
28038990A		2 mil Gloss Clear Antistatic Polyester	NPL	PET38	Optically clear for high clarity applications.
0801L1E84		2 mil Clear Polypropylene	PA-T1E	8K	Polypropylene with the soft feel of PVC.
400502211		2 mil Clear Polypropylene	PA-T1E	PET38	
28021250C		4 mil Matte Clear Polypropylene	M246C*	11GM	Ultra removable adhesive



LINTEC OF AMERICA, INC.

1292 Barclay Blvd.
Buffalo Grove, IL 60089

Tel: 847.229.0547
Fax: 847.229.0548

Toll free: 800.806.8977
www.lintecofamerica.com

Pressure Sensitive Adhesive System

Diagram A–F

- Release Liner Removal
- Film Application
- Film Trimming
- Final Squeegee

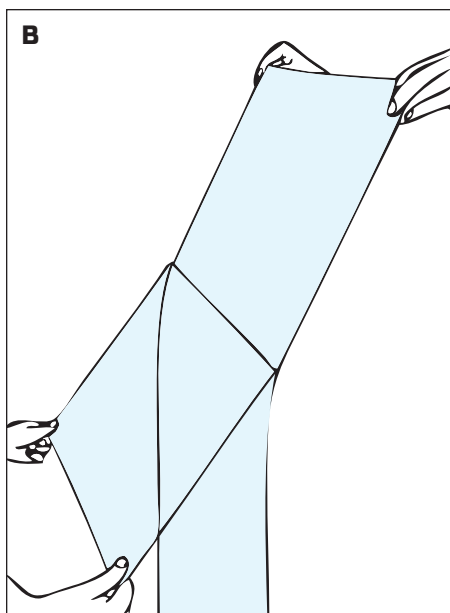
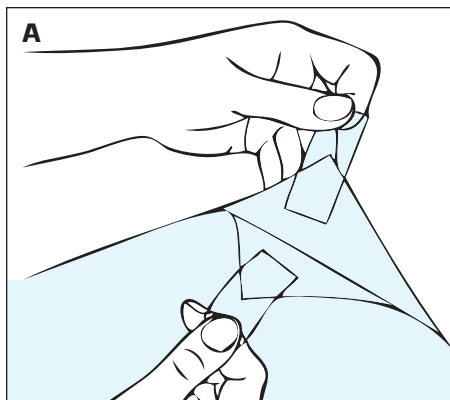

EQUIPMENT

- Application solution (in spray container, properly mixed)
- Squeegee
- Edge guide tool
- Trimming knife
- Pressure sensitive tape
- Razor scraper
- Paper towel (a lint free towel is best)

Lintec application solution and squeegees are highly recommended for proper installation

Lintec squeegees are softer and less likely to scratch film than standard squeegees.

A standard 32 ounce spray bottle full of warm distilled water mixed with 3 drops of dishwashing fluid can be used as application fluid in a pinch.

A complete Lintec installation kit including application solution is available by calling Lintec at the number on the bottom of the page.

Lintec application solution and squeegees can also be purchased separately.

1. COMPLETELY CLEAN WINDOW

- a. Place absorbent cloth on floor under the windows to collect excessive window solution.
- b. Wash window with solution and squeegee.
- c. Wet window with solution and scrape entire surface with razor scraper to remove any dirt particles.
- d. Wash and squeegee again.
- e. Wipe edges carefully with paper towel.
- f. Make sure that all loose dirt is removed.

Cleaning the window completely and thoroughly is the single most important step.

2. FILM PREPARATION

- a. Take the film out of the box. Remove end plugs and protective plastic sleeve. Save packaging to protect balance of film when job is completed. Replace end plates and place the roll back in the box. Set the box in front of window so that release liner which protects the adhesive faces installer. The film can then be unrolled directly from the box.
- b. Measure window glass from inside the frame.
- c. Film width should be pre-cut at least 10mm wider than window.
- d. Soak window thoroughly with solution.
- e. Pull enough film from the box to overlap the top and bottom of the window by approximately 25mm and cut.
- f. Have assistant hold cut film, or place film against solution soaked window with release liner facing the installer. The solution on a window will hold film in place (with SR coated polyester film do not use wet window to hold film).

Visit Our Web Site at www.digitalwindowgraphics.com for More Information



LINTEC OF AMERICA, INC.

1292 Barclay Blvd.
Buffalo Grove, IL 60089

Tel: 847.229.0547
Fax: 847.229.0548

Toll free: 800.806.8977
www.lintecofamerica.com

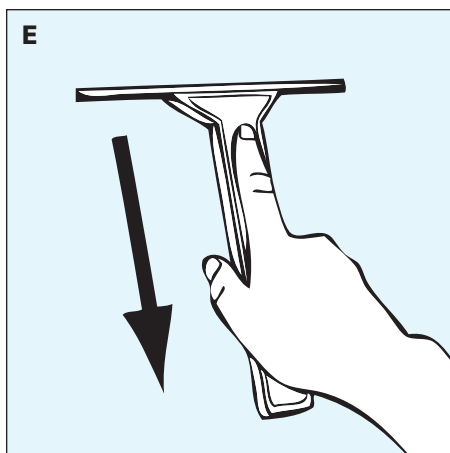
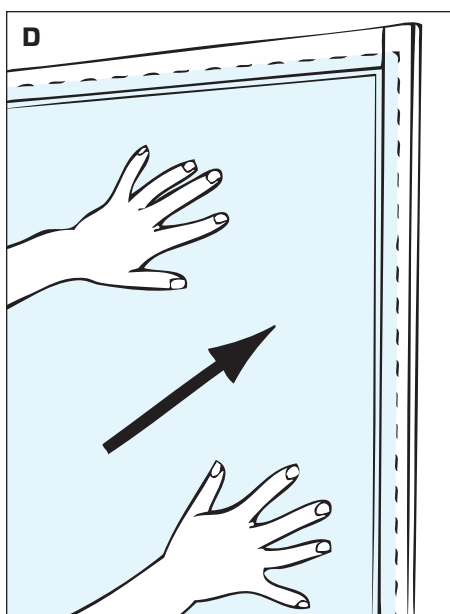
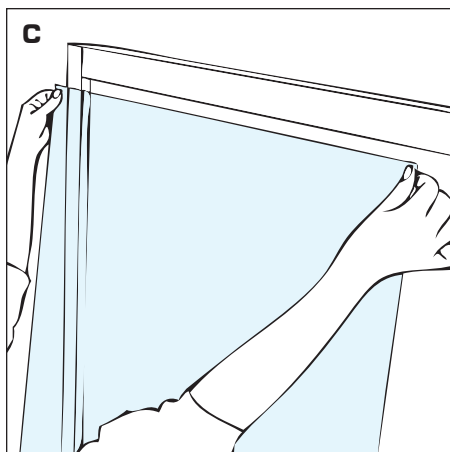

3. RELEASE LINER REMOVAL

The films are coated with pressure sensitive adhesive which must be kept clean. The adhesive is protected with a release liner and during application the release liner must be removed. Protect the film and exposed adhesive during the entire installation procedure. Do not let it touch anything but the glass on which it is to be installed.

- a. Apply pressure sensitive tape on one side of an upper corner of the film. Place a second piece of tape on same corner on the reverse side of film (see diagram A). Be careful not to let exposed tacky surfaces of the tape touch each other.
- b. Holding one piece of tape in each hand, pull the pieces of tape apart to separate the release liner from film.
- c. As you pull the liner off the film, begin to spray the adhesive surface with solution, completely soaking exposed adhesive. Continue pulling down on clear release sheet while spraying solution on adhesive. Solution will neutralize adhesive, preventing it from sticking to anything. Once initial removal of liner begins, try to pull it down evenly across the film (see diagram B). Discard release liner safely if using a scratch resistant WINCOS film. If not keep release liner for use as a mask during squeegee process.
- d. With adhesive surface completely exposed, spray one final time with solution to insure that 100 percent of adhesive is wet.

4. FILM APPLICATION

- a. Hold film at uppermost corners being careful not to allow film to touch floor or any other surface, place film on window with adhesive side against glass (see diagram C).
- b. The application solution acts as a lubricant making the window surface slippery. You can now slide the film so that one edge of film is 1–2mm from one side of window(see diagram D). Lift film if necessary to remove large wrinkles or bubbles. (For ease of installation the edge you select should be the one you favor, i.e. right side for right-handed people, left side for left-handed people. If fitted correctly this edge will not have to be trimmed. Other edges of the film should overlap top, bottom, and opposite edge of window.)
- c. Spray the surface side of the film facing you with solution. This acts as a lubricant for the squeegee. See note below for UV Printed window films.
- d. Beginning at the center of window, squeegee once to right side of window (see diagram E). Going back to the center, squeegee across to left hand edge of the window, then squeegee the window in straight, smooth strokes working from center out to the edges of the window until all excess application solution has been squeegeed out from under the film and film is lying flat. Note: the squeegee will not float across a dry surface, so re-lubricate with application solution as needed.

Please be aware that film can be scratched if a hard squeegee is used. Lintec scratch resistant film is highly recommended to prevent scratches in clear non image areas. If not using a scratch resistant version of WINCOS please use the release liner as a mask during the squeegee process.

Visit Our Web Site at www.digitalwindowgraphics.com for More Information



LINTEC OF AMERICA, INC.

1292 Barclay Blvd.
Buffalo Grove, IL 60089

Tel: 847.229.0547
Fax: 847.229.0548

Toll free: 800.806.8977
www.lintecofamerica.com

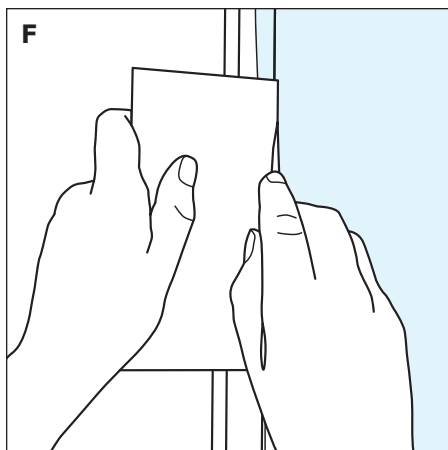

5. FILM TRIMMING

- a. Butt the edge guide tool against window frame, perpendicular to glass (see diagram F).
- b. With trimming knife and new sharp blade, trim excess film using edge guide tool to provide a narrow straight line border. Trim the bottom and side before top, so that trimmed film will not get in your way.
- c. Start trimming operation from corner but do not finish cutting into corner.
- d. Remove and discard all film scraps.

6. FINAL SQUEEGEE

- a. Once film is completely trimmed, spray the surface once more with application solution. Repeat squeegee operation as described in Step 4-d (see diagram G). Finally, using a wad of paper towels, gently wipe around edges of film to completely remove all excess water. This prevents the application solution from re-entering between the glass and film. Note on WINCOS UV printed films, many UV curable inks are not entirely water resistant. All that were tested by Lintec can be applied via wet solution, however, some added care is necessary. When applying the application solution on the film surface squeegee within 2 minutes. A soft squeegee is necessary to prevent smudging of the ink and scratching of film. A piece of the release liner can be used as a mask over the film when applying the film to glass to prevent scratching of film and ink. Lintec scratch resistant films are highly recommended to prevent scratching of clear non imaged areas during installation.

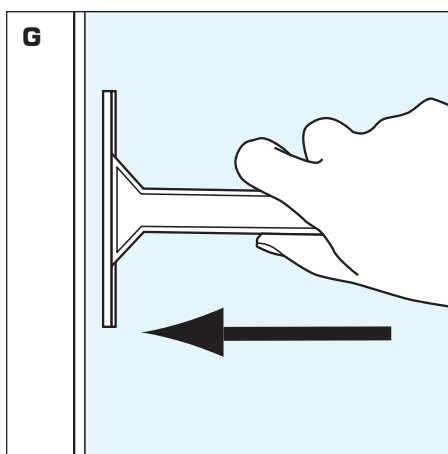

7. CLEANING & MAINTENANCE

- a. The film can be cleaned periodically using a soap and water solution. We recommend wetting a soft cloth with solution and then cleaning the window rather than directly spraying solution on the surface. **Never use harsh chemicals or cleaning agents such as Windex to clean the film surface.** The chemicals used in many window cleaning agents can attack the film's adhesive causing delamination from the window.

Visit Our Web Site at www.digitalwindowgraphics.com for More Information



LINTEC OF AMERICA, INC.

1292 Barclay Blvd.
Buffalo Grove, IL 60089

Tel: 847.229.0547
Fax: 847.229.0548

Toll free: 800.806.8977
www.lintecofamerica.com

Mistlass/Lumicool Optical Performance*

	Visible Rays Transmission	Ultraviolet Rays Transmission	Insolation			Shading Coefficient	Heat Transmission Coefficient	Shutter- proof	UV Resistance	Non- flammable	Surface	Width	Length
			Transmission	Reflectivity	Absorbency								
MST Series													
MST-5000 Superwhite	41	<1	43	25	32	0.62	6.0	○	○	○	Matt	1250	30
MST-5001 White mist	71	<1	68	16	16	0.83	6.0	○	○	○	Matt	1250	30
MST-5002 Mist	86	<1	82	8	10	0.97	6.0	○	○	○	Matt	970/1250	30
MST-5003 Fine mist	84	<1	79	10	11	0.94	6.0	○	○	○	Matt	1250	30
MST-5011 Washi	56	<1	57	22	21	0.73	6.0	○	○	○	Matt	1250	30
MST-5012 Soft	63	<1	63	16	21	0.80	6.0	○	○	○	Matt	1250	30
MST-5021 White pleats	78	<1	75	16	9	0.89	6.0	○	○	○	Hard Coat	1250	30
MST-5022 Punched	42	<1	46	33	21	0.34	6.0	○	○	○	Hard Coat	1250	30
MST-5023 White dots	63	<1	61	15	24	0.79	6.0	○	○	○	Hard Coat	1250	30
MST-5031 Gradation	50	<1	52	22	26	0.70	6.0	○	○	○	Hard Coat	1250	30
MST-5032 Wave	48	<1	50	23	27	0.68	6.0	○	○	○	Hard Coat	1250	30
MST-1301	70	<1	68	15	17	0.84	6.0	○	○	○	Matt	970/1250	50
MSV Series													
MSV-1001 Matt	87	<1	83	8	9	0.98	6.0	–	○	–	Matt	1250	30
MSV-1002 Textured matt	88	<1	84	7	9	0.99	6.0	–	○	–	Matt	970/1250	30
MSV-1002C Textured matt	88	<1	84	7	9	0.99	6.0	–	○	–	Matt	1250	30
MSV-1003 Matt blue	67	<1	71	7	22	0.89	6.0	–	○	–	Matt	1250	30
MSV-1004 Pearl green	50	<1	54	22	24	0.71	6.0	–	○	–	Matt	1250	30
MSV-1005 Crossroad	86	<1	79	8	13	0.95	6.0	–	○	–	Matt	1250	30
MSV-1006 Carbon	88	<1	82	8	10	0.97	6.0	–	○	–	Matt	1250	30
MSV-1007 Scrabble	84	<1	78	8	14	0.94	6.0	–	○	–	Matt	1250	30
MSV-1011 Rice Paper	69	<1	68	14	18	0.84	6.0	–	○	–	Matt	1250	30



Mistlass/Lumicool Optical Performance*

Heat Cracking

When applying window films, the temperature of glass rises and it may cause cracks. Conditions that could cause heat crack:

- The type of the glass
- The azimuth of the glass
- The shape/size of the window
- The installation situation of the window
- The type of graphic and absorption of heat

Caution

Mistlass window film is designed for indoor use only.

Not recommend for extremely humid environments like bathrooms and swimming pools.

Due to the material LOT #, there can be slight difference of color and texture.

Please use the same LOT when you use for adjacent area.

Some patterned Mistlass materials may have a different pitch due to splicing.

MSG Series

MSG series are manufactured using glass beads.

Due to characteristic of the print, it may cause the different pitch of printing or differences of color quality.

MSG series are not scratch resistant. Please handle with care.

About Interference Fringes

With products containing an abrasion resistant hard coat, a small haloling effect may appear under a fluorescent lamp or reflected sunlight.

This phenomenon is caused by reciprocal action between hard coat and light of the wave length. The film surface is sometimes visible as a rainbow color.

Maintenance after Installation

Cleaning

- As for usual cleaning, use a soft cloth and rinse with water. When the soiling is terrible, wash with neutral detergent and rinse well with water.
- Do not use ammonia, chlorine, or an organic type of detergent.
- Do not use cleanser, rough cloth, or paper towel to avoid the possibility of damaging the film surface.
- If you are joining film surfaces, please wipe according to the join.
- If the film is printed, spray the soft cloth first and then wipe the film. Do not marinate the ink in any fluids.
- If the film is printed by ink jet, we recommend wetting the soft cloth first with water and a neutral cleaning agent and then wiping the graphic.
We do not recommend spraying solution directly onto the ink jet surface.



Printerior™

Wallcoverings become made-to-order in the Digital Printing Era



LINTEC Corporation has long been a producer of fire retardant media for industrial applications. We have leveraged this capability into producing a textured, fireproof ink jet printable wall covering media. PRINTERIOR is also completely recyclable as opposed to traditional PVC based wall covering media.

We recommend that PRINTERIOR media be printed with water based pigment inks. For a list of recommended machines please contact LINTEC of America.

Media Description

Item	Finish	Dimensions
EM-100S	Stucco	36 inch x 166 feet
EM-200H	Linen	36 inch x 166 feet
EM-400F	Flat	36 inch x 166 feet



*Above pictures are all applied on same base image using different types of overlams.

Introducing REVI Overlamine Film REVI from Lintec of America

The new REVI overlaminates are iridescent clear polyester films with permanent acrylic adhesive and polyester release liner designed to maintain clarity. Make your images stand out with a unique iridescent metallic sheen that changes color when viewed from different angles. The Revi product line consists of 3 different iridescent color schemes that shift when viewed from the front to side angle. Attract attention using Revi overlaminate films to give your message an eye catching shimmer that can not be ignored.

Clear Printable Polyester Film

Item Code	Front View		Roll Width
	When Base Color is Black	When Base Color is White	
REVI-SD300	It changes to PURPLE	It changes to YELLOW	49"
REVI-SD700	It changes to GREEN	It Changes to PINK	
REVI-SD900	It changes to ORANGE	It Changes to BLUE	

Durability: Indoor use only.



Construction:

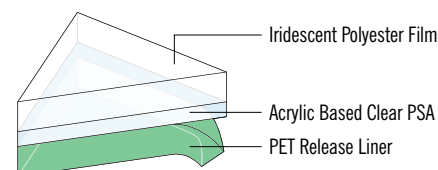

LINTEC OF AMERICA, INC.

1292 Barclay Blvd.
Buffalo Grove, IL 60089

Tel: 847.229.0547
Fax: 847.229.0548
Toll free: 800.806.8977

www.lintecofamerica.com
www.digitalwindowgraphics.com

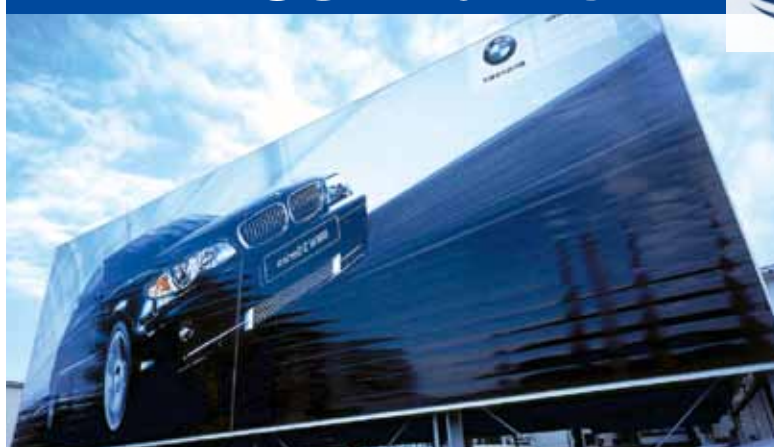

Reliable & Highest Quality

LINTEC is pleased to introduce a new lineup of **low-solvent inkjet printable materials**.

LINTEC's **SSJ** (Soft Solvent Jet) Media are ideally suited for making **clear film displays for glass**, as well as **labels and decals**.

LINTEC's clear printing and mounting films are produced in state-of-the-art **clean facilities**, ensuring that your window graphics and glass decorated products will be of the **highest quality**.

SSJ Polyester Films for Solvent Printing

Item Code	Description	Thickness	Size	Adhesive	Usage
E-1000ZC	2 mil Topcoated Clear PET	2 mil	48" x 164'	Permanent	Indoor
E-1004RC	2 mil Topcoated Clear PET	2 mil	48" x 164'	Removable	Indoor
G-1100EC	2 mil Topcoated Clear PET	2 mil	48" x 164'	None	Indoor
E-1005ZW	3 mil Topcoated White PET	3 mil	54" x 98'	Permanent	Indoor
E-434ZW	3 mil White PET Backer	3 mil	54" x 150'	Permanent	Indoor

How SSJ Works

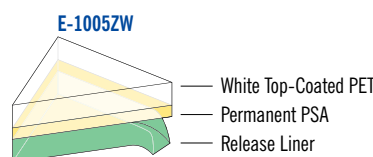
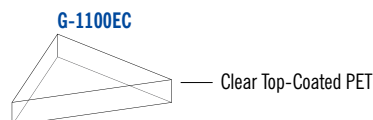
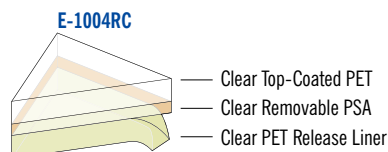
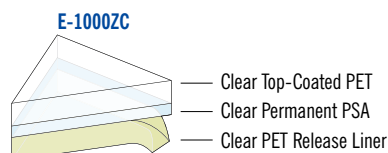

SSJ PVC Films for Solvent Printing

Item Code	Description	Thickness	Size	Adhesive	Usage
M-010PN80	Dusted (Frosted) PVC	3 mil	49" x 98'	Permanent	Indoor
MSV-1001	Matte Textured PVC	5 mil	49" x 98'	Permanent	Indoor
MSV-1002	Pebbled Textured PVC	6 mil	49" x 98'	Permanent	Indoor
MSV-1005	Crossroad Textured PVC	6 mil	49" x 98'	Permanent	Indoor
MSV-1006	Carbon (Checkered) PVC	6 mil	49" x 98'	Permanent	Indoor
MSV-1007	Scramble Textured PVC	6 mil	49" x 98'	Permanent	Indoor
MSV-1011	Mino (Rice Paper) PVC	5 mil	49" x 98'	Permanent	Indoor
P-291ZW	White Polymeric PVC	3 mil	36" x 164'	Permanent	Outdoor
P-291ZW	White Polymeric PVC	3 mil	61" x 164'	Permanent	Outdoor



Solvent Printable Polyester E1000ZC/E10004RC/G1100EC



PRODUCT DESCRIPTION

A range of printable window films with high coat-weight topcoatings designed to absorb solvent based inks. These topcoatings are very reactive to the solvents selected in the printing process. The ideal scenario is to achieve the optimum print definition and saturation with the minimum of ink deposit; this requires precise setting of profiles and curing conditions.

ACCLIMATISATION

Prior to printing, store the material in the machine room for a minimum of 24 hours to acclimatize the product.

INK DEPOSIT

The ink selected should adhere to the topcoat but should not be aggressive enough to attack and breakdown the topcoat. The digital inks should be evaluated to determine their effect on the topcoat. Mild solvent inks are more suitable for this film as it has a very ink receptive topcoating. The ink limit evaluation should be the minimum profile run on the material so as to ensure that no over-inking is taking place. Linearization and ICC profile should be set up for this material.

INK CURE

The recommendations for cure of the printed image are as follows:

1. The pre-heat of the printing machine is set to room temperature (25°C) to ensure that the topcoating is not softened and more re-active to the solvents.

2. The print head temperature should be set to 35°C to ensure that the solvents start to slowly volatilize.
3. The post cure temperature should be set at 50°C to 60°C to further assist the release of solvents.
4. The cure/drying recommendations above try to ensure that the printed material is dried as efficiently as possible without introducing internal stresses into the film due to solvent attack or overheating.

IMPORTANT NOTE

If the film is not cured correctly it can introduce up-curl or 'wavy edges' into the product. As the film is designed to be wet applied any curl can cause application issues. Product curl at point of the application can cause delamination of the film from the glass. It is essential to evaluate all profiles and drying conditions as detailed within this document to ensure good lay-flat properties after printing.

PRINTED MATERIAL HANDLING

Once the print has dried, the material should ideally be hung or left on a flat table to post cure. At this time the ink surface should be exposed to the air and not be in contact with another surface. We recommend 48 hours for the cure/drying time before installation. Ensure the ink is fully dry before rewinding. If the ink is not fully cured there is a risk of 'blocking' where the uncured ink bonds to the release liner when it is rewound onto a roll.

PACKAGING FOR TRANSPORTATION

The media should be wound around a tube with ink out facing, poly bagged and then boxed.

APPLICATION

1. The printed materials should be trimmed with new sharp cutting blade.
2. The area where the film is to be applied should be clean and free of any contamination such as silicone.
3. The printed film should be applied using the Madico application fluid, Blue solution, to ensure activation of the adhesive whilst using wet application methods. See separate LINTEC Application Instructions leaflet.

The representations of performance and suitability for use contained in this Data Sheet are meant only as a guide. Since only the user is aware of the specific conditions in which the product is to be used, it is the user's responsibility to determine whether the product is suitable for that intended use. Copyright 1995



LINTEC OF AMERICA, INC.

1292 Barclay Blvd.
Buffalo Grove, IL 60089

Tel: 847.229.0547
Fax: 847.229.0548

Toll free: 800.806.8977
www.lintecofamerica.com

Lintec Digital Window Graphics Basic Warranty

Lintec warrants to the distributor and digital print provider that the Digital Window Graphics product line will be free of defects in material and manufacture when properly applied to a flat interior glass surface of a building or structure for a period specified in table 1 from the date of the film purchase.

Digital Window Graphics Warranty Coverage

In the unlikely event that a Lintec Digital Window Graphics Film should experience adhesive failure, bubbling, cracking, delamination, or discoloration, Lintec will provide replacement film to the distributor, digital print provider, or end user for a period specified in table 1.

Warranted Durability

Lintec offers a warranted durability period as stated in the Lintec Durability Table below. The coverage period begins at the date of the film purchase. This expected durability period is based on non imaged or processed film applied to interior flat substrates in non abusive environments.

Table 1: Lintec Durability Table

Product Name	Indoor Durability	Adhesive Type
E-1004RC	1 Year	Removable*
E-1000ZC	1 Year	Permanent
E-2001RC	1 Year	Removable*
E-2000ZC	1 Year	Permanent
E-2100ZC	1 Year	Permanent
E-2201RC	1 Year	Removable*
E-2200ZC	5 Year	Permanent
MISTLASS	1 Year	Permanent

* Lintec film is considered removable if the film can be removed with heat and/or chemicals within the durability period and leaves thirty percent (30%) or less adhesive residue.

Warranty Limitations

Fit for Use Limitation: Lintec does not warranty the film for any particular use. Since only the user is aware of the specific conditions in which the product will be used, it is the user's responsibility to determine whether the product is suitable for that intended application.

Printing Limitation: Lintec does not warranty the film for satisfactory printing. Lintec will not warranty against ink performance failures such as ink fading, cracking, peeling, scratching, or any other ink related issues. Lintec film should be tested and approved with the printer and ink combination prior to application.

Installation Limitation: Lintec does not warranty film installation performed by third party installers. Responsibility for defects or failures resulting from improper installation is transferred to the third party installers.

Remedy Limitation: Lintec does not provide compensation for machine time, overhead, travel, supervisions, lost profits or other consequential damages. Lintec does not provide compensation for damage resulting from graphic removal.

Product Misuse Limitation: This warranty does not cover Lintec film that have been damaged through improper storage, misuse, vandalism, abuse, neglect, or mishandling of finished or unfinished products by any person.

Glass Breakage Limitation: This warranty does not cover any type of glass breakage.

Liability Limitation

Lintec's complete liability for the Basic Digital Window Graphics Warranty is replacement or credit for the defective Lintec product for the warranted durability period. Warranty repair liability shall in no case exceed a value greater than the original invoiced amount, nor shall warranty repair remedies be extended to anyone other than the company that originally purchased the film. Installing warranty replacement film will not renew or extend the original warranted durability time period on table 1.

Film Dry Out Time

The mounting solution used during the installation of your Lintec Digital Window Graphics window films may require a period of time to dry out. Cold and/or cloudy weather conditions can lengthen the dry out time of a Lintec Digital Window Graphics film. Warm weather and direct sunlight exposure will shorten the dry out time. Small water beads and a slightly cloudy look are common and may appear during the dry out period. If slow drying occurs, do not be alarmed since it is the part of the natural curing process. Do not install Lintec Digital Window Graphics film on the interior of single pane glass if the temperature is below 32°F.

Window Film Care & Maintenance

Do not clean the film for 30 days after installation to allow proper curing of the adhesive system to the glass. Do not use bristle brushes, abrasive scrubbing sponges, or any other abrasive cleaning materials that could scratch the film. Always use soft clean materials to wash and dry the window film surface. NEVER USE HARSH CHEMICALS OR CLEANING AGENTS SUCH AS WINDEX TO CLEAN THE WINDOW FILM SURFACE. The chemicals used in many harsh cleaning agents can attack the adhesive at the film edge causing delamination from the window. Use a soapy water solution such as dishwashing fluid and water to clean the film surface. Do not spray this soapy water solution directly onto the film since prolonged exposure to moisture can reduce the scratch resistance of many uv curable inks. Spray the soapy water directly into a soft clean cloth and proceed to wipe down the film surface. Improper care and maintenance will void the warranty.

January 2014



Lintec Digital Window Graphics Premium Warranty

Lintec warrants to the distributor and digital print provider that the Digital Window Graphics product line will be free of defects in material and manufacture when properly applied to a flat interior glass surface of a building or structure for a period specified in table 1 from the date of the film purchase. The Lintec premium level warranty also covers the film installation performed by a certified Lintec installer and invoiced by Lintec of America for the period specific in table 1 from the date of the film purchase.

Digital Window Graphics Warranty Coverage

In the unlikely event that a Lintec Digital Window Graphics Film should experience adhesive failure, bubbling, cracking, delamination, or discoloration, Lintec will provide replacement film, removal of defective film and reinstallation of replacement film to the distributor, digital print provider, or end user for a period specified in table 1.

Warranted Durability

Lintec offers a warranted durability period as stated in the Lintec Durability Table below. The coverage period begins at the date of the film purchase. This expected durability period is based on non imaged or processed film applied to interior flat substrates in non abusive environments.

Table 1: Lintec Durability Table

Product Name	Indoor Durability	Adhesive Type
E-1004RC	1 Year	Removable*
E-1000ZC	1 Year	Permanent
E-2001RC	1 Year	Removable*
E-2000ZC	1 Year	Permanent
E-2100ZC	1 Year	Permanent
E-2201RC	1 Year	Removable*
E-2200ZC	5 Year	Permanent
MISTLASS	1 Year	Permanent

* Lintec film is considered removable if the film can be removed with heat and/or chemicals within the durability period and leaves thirty percent (30%) or less adhesive residue.

Warranty Limitations

Fit for Use Limitation: Lintec does not warranty the film for any particular use. Since only the user is aware of the specific conditions in which the product will be used, it is the user's responsibility to determine whether the product is suitable for that intended application.

Printing Limitation: Lintec does not warranty the film for satisfactory printing. Lintec will not warranty against ink performance failures such as ink fading, cracking, peeling, scratching, or any other ink related issues. Lintec film should be tested and approved with the printer and ink combination prior to application.

Remedy Limitation: Lintec does not provide compensation for machine time, overhead, travel, supervisions, lost profits or other

consequential damages. Lintec does not provide compensation for damage resulting from graphic removal.

Product Misuse Limitation: This warranty does not cover Lintec film that have been damaged through improper storage, misuse, vandalism, abuse, neglect, or mishandling of finished or unfinished products by any person.

Glass Breakage Limitation: This warranty does not cover any type of glass breakage.

Liability Limitation

Lintec's complete liability for the Premium Digital Window Graphics Warranty is replacement or credit for the defective Lintec product, removal of defective film, and reinstallation of replacement film for the warranted durability period. Warranty repair liability shall in no case exceed a value greater than the original invoiced amount, nor shall warranty repair remedies be extended to anyone other than the company that originally purchased the film. Installing warranty replacement film will not renew or extend the original warranted durability time period on table 1.

Film Dry Out Time

The mounting solution used during the installation of your Lintec Digital Window Graphics window films may require a period of time to dry out. Cold and/or cloudy weather conditions can lengthen the dry out time of a Lintec Digital Window Graphics film. Warm weather and direct sunlight exposure will shorten the dry out time. Small water beads and a slightly cloudy look are common and may appear during the dry out period. If slow drying occurs, do not be alarmed since it is the part of the natural curing process. Do not install Lintec Digital Window Graphics film on the interior of single pane glass if the temperature is below 32°F.

Window Film Care & Maintenance

Do not clean the film for 30 days after installation to allow proper curing of the adhesive system to the glass. Do not use bristle brushes, abrasive scrubbing sponges, or any other abrasive cleaning materials that could scratch the film. Always use soft clean materials to wash and dry the window film surface. **NEVER USE HARSH CHEMICALS OR CLEANING AGENTS SUCH AS WINDEX TO CLEAN THE WINDOW FILM SURFACE.** The chemicals used in many harsh cleaning agents can attack the adhesive at the film edge causing delamination from the window. Use a soapy water solution such as dishwashing fluid and water to clean the film surface. Do not spray this soapy water solution directly onto the film since prolonged exposure to moisture can reduce the scratch resistance of many uv curable inks. Spray the soapy water directly into a soft clean cloth and proceed to wipe down the film surface. Improper care and maintenance will void the warranty.

January 2014



Pressure Sensitive Adhesive System

Diagram A–F

- Release Liner Removal
- Film Application
- Film Trimming
- Final Squeegee

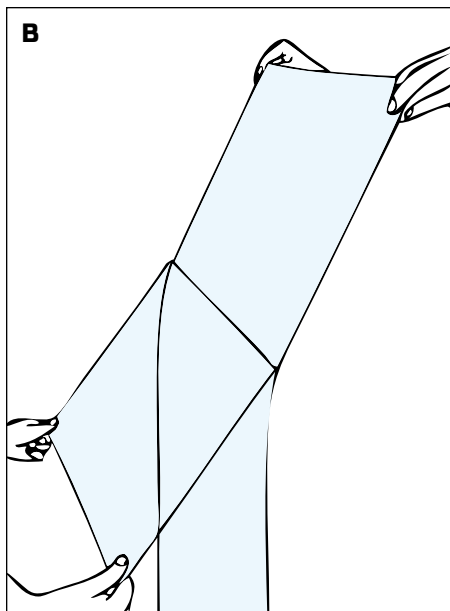
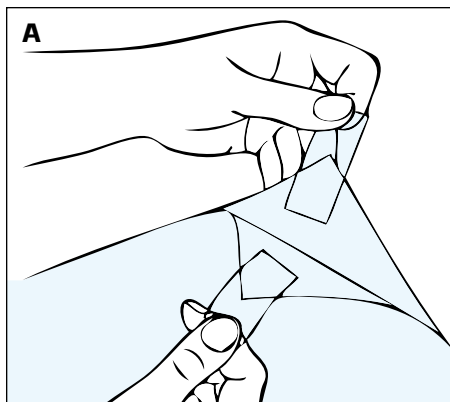

EQUIPMENT

- Application solution (in spray container, properly mixed)
- Squeegee
- Edge guide tool
- Trimming knife
- Pressure sensitive tape
- Razor scraper
- Paper towel (a lint free towel is best)

Lintec application solution and squeegees are highly recommended for proper installation

Lintec squeegees are softer and less likely to scratch film than standard squeegees

A mixture of 3 drops of Joy dishwashing fluid with 1 gallon of warm water can be used as application solution in a pinch

A complete Lintec installation kit including application solution is available by calling Lintec at the number on the bottom of the page

Lintec application solution and squeegees can also be purchased separately

1. COMPLETELY CLEAN WINDOW

- Place absorbent cloth on floor under the windows to collect excessive window solution.
- Wash window with solution and squeegee.
- Wet window with solution and scrape entire surface with razor scraper to remove any dirt particles.
- Wash and squeegee again.
- Wipe edges carefully with paper towel.
- Make sure that all loose dirt is removed.

Cleaning the window completely and thoroughly is the single most important step.

2. FILM PREPARATION

- Take the film out of the box. Remove end plugs and protective plastic sleeve. Save packaging to protect balance of film when job is completed. Replace end plates and place the roll back in the box. Set the box in front of window so that release liner which protects the adhesive faces installer. The film can then be unrolled directly from the box.
- Measure window glass from inside the frame.
- Film width should be pre-cut at least 10mm wider than window.
- Soak window thoroughly with solution.
- Pull enough film from the box to overlap the top and bottom of the window by approximately 25mm and cut.
- Have assistant hold cut film, or place film against solution soaked window with release liner facing the installer. The solution on a window will hold film in place (with SR coated polyester film do not use wet window to hold film).

Visit Our Web Site at www.digitalwindowgraphics.com for More Information



LINTEC OF AMERICA, INC.

1292 Barclay Blvd.
Buffalo Grove, IL 60089

Tel: 847.229.0547
Fax: 847.229.0548

Toll free: 800.806.8977
www.lintecofamerica.com

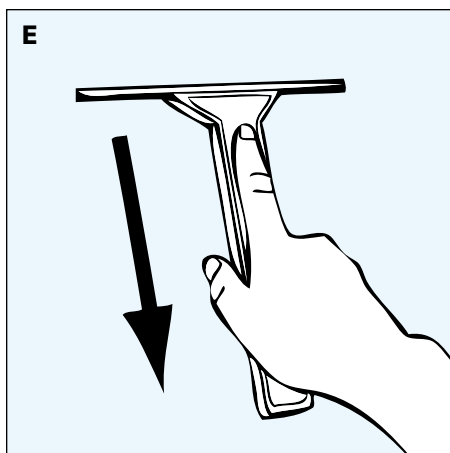
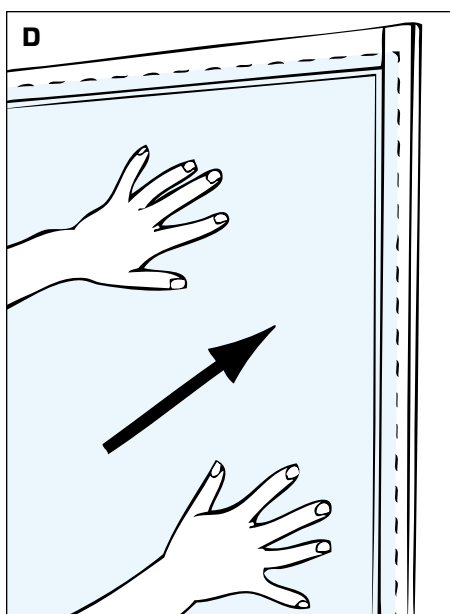
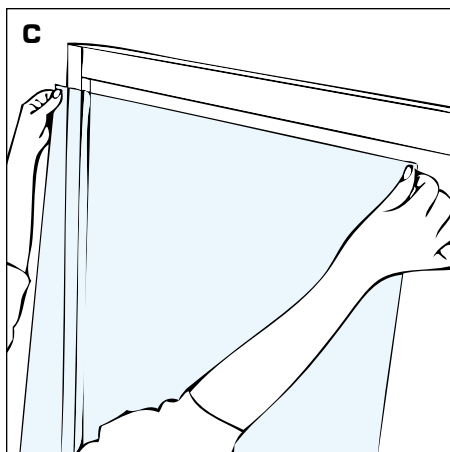

3. RELEASE LINER REMOVAL

The films are coated with pressure sensitive adhesive which must be kept clean. The adhesive is protected with a release liner and during application the release liner must be removed. Protect the film and exposed adhesive during the entire installation procedure. Do not let it touch anything but the glass on which it is to be installed.

- Apply pressure sensitive tape on one side of an upper corner of the film. Place a second piece of tape on same corner on the reverse side of film (see diagram A). Be careful not to let exposed tacky surfaces of the tape touch each other.
- Holding one piece of tape in each hand, pull the pieces of tape apart to separate the release liner from film.
- As you pull the liner off the film, begin to spray the adhesive surface with solution, completely soaking exposed adhesive. Continue pulling down on clear release sheet while spraying solution on adhesive. Solution will neutralize adhesive, preventing it from sticking to anything. Once initial removal of liner begins, try to pull it down evenly across the film (see diagram B). Discard release liner safely.
- With adhesive surface completely exposed, spray one final time with solution to insure that 100 percent of adhesive is wet.

4. FILM APPLICATION

- Hold film at uppermost corners being careful not to allow film to touch floor or any other surface, place film on window with adhesive side against glass (see diagram C).
- The application solution acts as a lubricant making the window surface slippery. You can now slide the film so that one edge of film is 1–2mm from one side of window (see diagram D). Lift film if necessary to remove large wrinkles or bubbles. (For ease of installation the edge you select should be the one you favor, i.e. right side for right-handed people, left side for left-handed people. If fitted correctly this edge will not have to be trimmed. Other edges of the film should overlap top, bottom, and opposite edge of window.)
- Spray the surface side of the film facing you with solution. This acts as a lubricant for the squeegee. See note below for UV Printed window films.
- Beginning at the center of window, squeegee once to right side of window (see diagram E). Going back to the center, squeegee across to left hand edge of the window, then squeegee the window in straight, smooth strokes working from center out to the edges of the window until all excess application solution has been squeegeed out from under the film and film is lying flat. Do not be afraid to squeegee too hard, it will not damage film and it is important to remove as much water and solution from under the film. Note: the squeegee will not float across a dry surface, so re-lubricate with application solution as needed.

Visit Our Web Site at www.digitalwindowgraphics.com for More Information



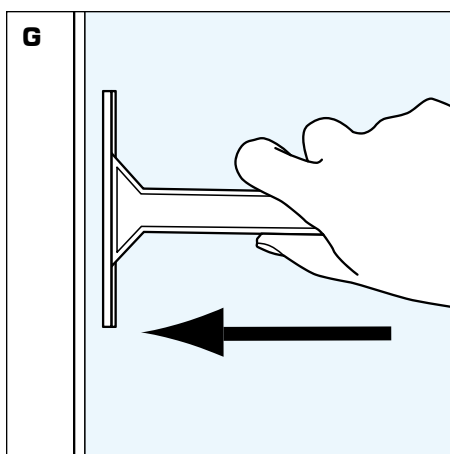
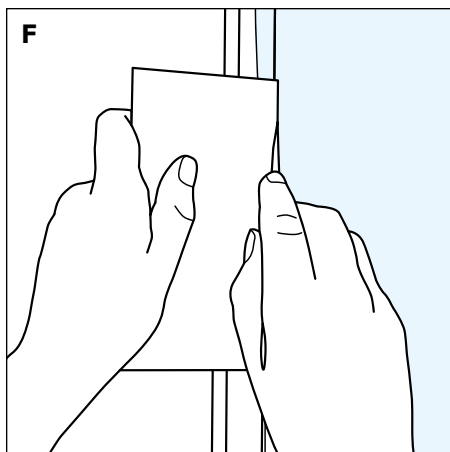

5. FILM TRIMMING

- a. Butt the edge guide tool against window frame, perpendicular to glass (see diagram F).
- b. With trimming knife and new sharp blade, trim excess film using edge guide tool to provide a narrow straight line border. Trim the bottom and side before top, so that trimmed film will not get in your way.
- c. Start trimming operation from corner but do not finish cutting into corner.
- d. Remove and discard all film scraps.

6. FINAL SQUEEGEE

- a. Once film is completely trimmed, spray the surface once more with application solution. Repeat squeegee operation as described in Step 4-d (see diagram G). Finally, using a wad of paper towels, gently wipe around edges of film to completely remove all excess water. This prevents the application solution from re-entering between the glass and film. Note on WINCOS UV printed films, many UV curable inks are not entirely water resistant. All that were tested by Lintec can be applied via wet solution, however, some added care is necessary. When applying the application solution on the film surface squeegee within 2 minutes. **A soft squeegee is necessary to prevent smudging of the ink.** A piece of the release liner can be used a mask over the printed image when applying the film to glass as well.

7. CLEANING & MAINTENANCE

- a. The film can be cleaned periodically using a soap and water solution. **Never use harsh chemicals or cleaning agents such as windex to clean the film surface.** The chemicals used in many window cleaning agents can attack the film's adhesive causing delamination from the window.

Visit Our Web Site at www.digitalwindowgraphics.com for More Information



LINTEC OF AMERICA, INC.

1292 Barclay Blvd.
Buffalo Grove, IL 60089

Tel: 847.229.0547
Fax: 847.229.0548

Toll free: 800.806.8977
www.lintecofamerica.com